

## Deflector hoods, flange connection

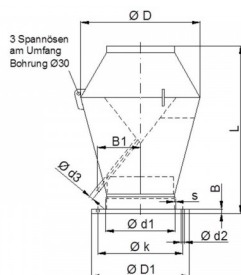

### Popis

Ventilation Components Defl ector cowls

### PVC

#	d	d	L	s PVC	s PP-Basis	B1	d3	d1	B	k	d1	d2	Anzahl d2	kg
1	0700f	1140	1410	6,0	-	450	63	810	12	770	700	11	24	69,0
2	0710f	1140	1410	-	8,0	450	63	810	12	770	710	11	24	75,0
3	0800f	1295	1585	8,0	8,0	535	75	900	12	860	800	11	28	80,0
4	0900f	1455	1780	7,0	8,0	595	75	1000	12	960	900	11	32	102,0
5	1000f	1650	2030	8,0	10,0	620	75	1100	12	1060	1000	11	32	127,0
6	1250f	2075	2550	10,4	10,0	750	75	1350	15	1310	1250	11	32	159,0
7	1400f	2335	2900	10,0	12,0	825	75	1500	15	1460	1400	11	32	178,0

### PPs

#	d	d	L	s PVC	s PP-Basis	B1	d3	d1	B	k	d1	d2	Anzahl d2	kg
1	0700f	1140	1410	6,0	-	450	63	810	12	770	700	11	24	69,0
2	0710f	1140	1410	-	8,0	450	63	810	12	770	710	11	24	75,0
3	0800f	1295	1585	8,0	8,0	535	75	900	12	860	800	11	28	80,0
4	0900f	1455	1780	7,0	8,0	595	75	1000	12	960	900	11	32	102,0
5	1000f	1650	2030	8,0	10,0	620	75	1100	12	1060	1000	11	32	127,0
6	1250f	2075	2550	10,4	10,0	750	75	1350	15	1310	1250	11	32	159,0
7	1400f	2335	2900	10,0	12,0	825	75	1500	15	1460	1400	11	32	178,0

## PP

#	d	d	L	s PVC	s PP-Basis	B1	d3	d1	B	k	d1	d2	Anzahl d2	kg
1	0700f	1140	1410	6,0	-	450	63	810	12	770	700	11	24	69,0
2	0710f	1140	1410	-	8,0	450	63	810	12	770	710	11	24	75,0
3	0800f	1295	1585	8,0	8,0	535	75	900	12	860	800	11	28	80,0
4	0900f	1455	1780	7,0	8,0	595	75	1000	12	960	900	11	32	102,0
5	1000f	1650	2030	8,0	10,0	620	75	1100	12	1060	1000	11	32	127,0
6	1250f	2075	2550	10,4	10,0	750	75	1350	15	1310	1250	11	32	159,0
7	1400f	2335	2900	10,0	12,0	825	75	1500	15	1460	1400	11	32	178,0

## PE

#	d	d	L	s PVC	s PP-Basis	B1	d3	d1	B	k	d1	d2	Anzahl d2	kg
1	0700f	1140	1410	6,0	-	450	63	810	12	770	700	11	24	69,0
2	0710f	1140	1410	-	8,0	450	63	810	12	770	710	11	24	75,0
3	0800f	1295	1585	8,0	8,0	535	75	900	12	860	800	11	28	80,0
4	0900f	1455	1780	7,0	8,0	595	75	1000	12	960	900	11	32	102,0
5	1000f	1650	2030	8,0	10,0	620	75	1100	12	1060	1000	11	32	127,0
6	1250f	2075	2550	10,4	10,0	750	75	1350	15	1310	1250	11	32	159,0
7	1400f	2335	2900	10,0	12,0	825	75	1500	15	1460	1400	11	32	178,0

## PPs-el

#	d	d	L	s PVC	s PP-Basis	B1	d3	d1	B	k	d1	d2	Anzahl d2	kg
1	0700f	1140	1410	6,0	-	450	63	810	12	770	700	11	24	69,0
2	0710f	1140	1410	-	8,0	450	63	810	12	770	710	11	24	75,0
3	0800f	1295	1585	8,0	8,0	535	75	900	12	860	800	11	28	80,0
4	0900f	1455	1780	7,0	8,0	595	75	1000	12	960	900	11	32	102,0
5	1000f	1650	2030	8,0	10,0	620	75	1100	12	1060	1000	11	32	127,0
6	1250f	2075	2550	10,4	10,0	750	75	1350	15	1310	1250	11	32	159,0
7	1400f	2335	2900	10,0	12,0	825	75	1500	15	1460	1400	11	32	178,0

## PVDF

#	d	d	L	s PVC	s PP-Basis	B1	d3	d1	B	k	d1	d2	Anzahl d2	kg
1	0700f	1140	1410	6,0	-	450	63	810	12	770	700	11	24	69,0
2	0710f	1140	1410	-	8,0	450	63	810	12	770	710	11	24	75,0
3	0800f	1295	1585	8,0	8,0	535	75	900	12	860	800	11	28	80,0
4	0900f	1455	1780	7,0	8,0	595	75	1000	12	960	900	11	32	102,0
5	1000f	1650	2030	8,0	10,0	620	75	1100	12	1060	1000	11	32	127,0
6	1250f	2075	2550	10,4	10,0	750	75	1350	15	1310	1250	11	32	159,0
7	1400f	2335	2900	10,0	12,0	825	75	1500	15	1460	1400	11	32	178,0

## PVC-UV

#	d	d	L	s PVC	s PP-Basis	B1	d3	d1	B	k	d1	d2	Anzahl d2	kg
1	0700f	1140	1410	6,0	-	450	63	810	12	770	700	11	24	69,0
2	0710f	1140	1410	-	8,0	450	63	810	12	770	710	11	24	75,0
3	0800f	1295	1585	8,0	8,0	535	75	900	12	860	800	11	28	80,0
4	0900f	1455	1780	7,0	8,0	595	75	1000	12	960	900	11	32	102,0
5	1000f	1650	2030	8,0	10,0	620	75	1100	12	1060	1000	11	32	127,0
6	1250f	2075	2550	10,4	10,0	750	75	1350	15	1310	1250	11	32	159,0
7	1400f	2335	2900	10,0	12,0	825	75	1500	15	1460	1400	11	32	178,0

---

Technické údaje o produktech nejsou závazné. Konstrukční a rozměrové změny vyhrazeny.  
Přeloženo z originálu výrobce.

Farprosys, s.r.o.  
email: [info@farprosys.com](mailto:info@farprosys.com)  
tel. +420 728 757 770  
[www.atexventilatory.cz](http://www.atexventilatory.cz)